

Installation Instructions – EXM-MCXPLUS®

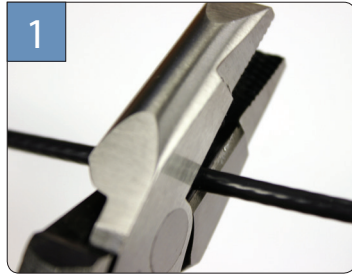

1 Cut cable squarely.

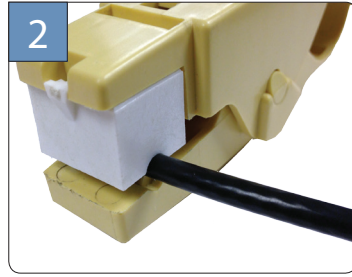

2 Using a fixed blade, mini prep tool in good condition, prepare cable to 1/4" x 1/4" dimensions. Use edge of tool if no stop

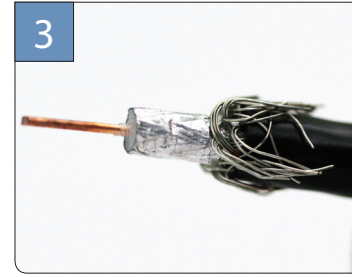

3 Fold back braid. If Trishield or Quadshield remove additional foil layer and fold back remaining braid.



4 Ensure cable preparation is correct. Use gauge on VT tool to check the center conductor length.

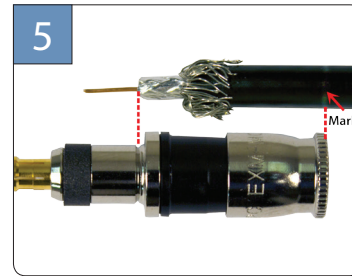

5 Align the cable with the connector and mark the cable jacket for proper installation depth as shown above.

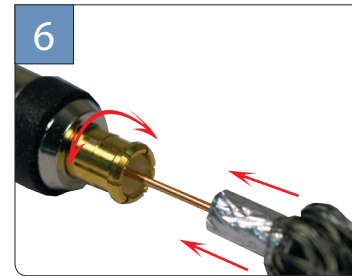

6 Insert cable center conductor into the pin stored within the MCX male plug. Push into the pin while rotating the connector.

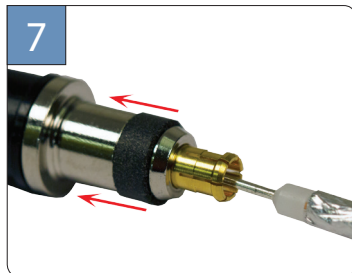

7 Once the center conductor is pressed fully into the pin pull the connector away from the cable. The step down pin and insulator guide will stay with the cable as shown.

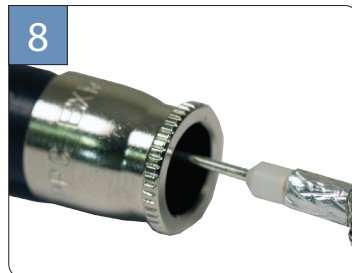

8 Insert the cable into the back of the connector with the step down pin and insulator guide inside the post. Push the connector on while rotating until fully seated.

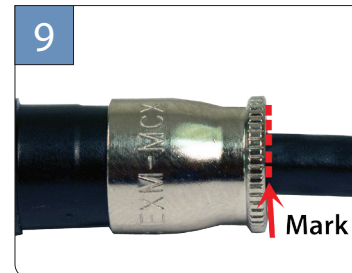

9 The cable mark from step 5 should line up with the back edge of the compression ring.



10 Using your VT-HE compression tool, make sure the rotating compression head is positioned for MCX as shown in the picture. Properly seat connector and compress fully.



11 Insert connector.

EXM-MCXPLUS



Part Number Description

EXM-MCXPLUS SignalTight, Mini Series, MCX-Connector

VT-HE

LDT-MINI

