

# PP1015BAFFTX/PP1015FMTX

## Installation Instructions



Tools needed:  
 (2) Adjustable Wrenches  
 (1) Prep tool: PN SDT-TXFF-250  
 (1) Insertion tool: PN TX1015-T



Insert the cable into the prep tool in the direction the arrow points on the tool. Make sure the end of the cable is flush with the tool.

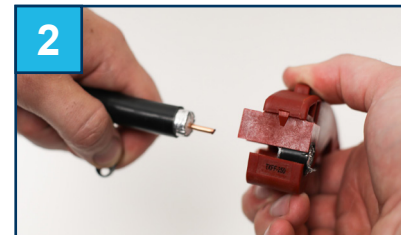

Rotate the tool around the cable to cut through the jacket, braid and dielectric. Pinch the tool on top of the cable and spin an additional turn, then pull the tool off axially to remove the cut jacket, braid and dielectric.

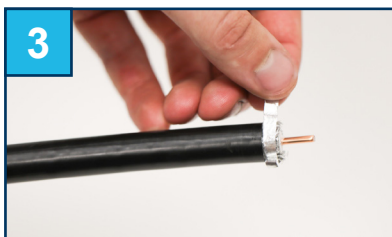

Peel off the exposed foil layer, using pliers to assist if needed.

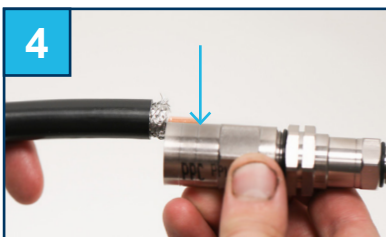

Check the center conductor prep length using the second groove on the back body of the connector.

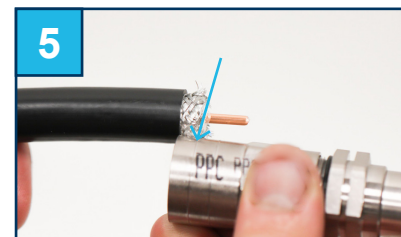

Check the length of the exposed braid using the first groove on the back body of the connector.

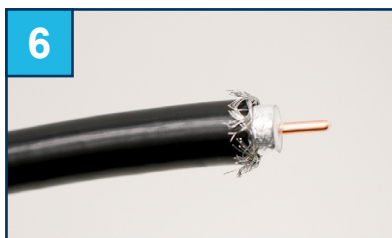

Peel back the exposed braid to ensure the connector can be installed smoothly.

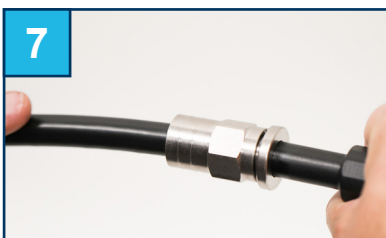

Use an insertion tool to aid in the installation of the connector back body on to the cable. Continue to push and rotate the tool until the connector is fully installed.



Proper installation is when you can visually ensure the dielectric is flush with the end of the connector.



Hand tighten the connector by holding the front body stationary while rotating the back body of the connector. Then use two adjustable wrenches to fully tighten until positive stop.

### Ordering Information

Part Number	Description
PP1015BAFFTX	500 Flex Feeder (1015TX) to F-Female Connector
PP1015FMTX	500 Flex Feeder (1015TX) to F-Male Connector

This product may be protected by one or more patents • For further information, please visit: [www.ppc-online.com/patents](http://www.ppc-online.com/patents)

6176 E. Molloy Rd. East Syracuse, NY 13057 U.S.A. • [customerservice@ppc-online.com](mailto:customerservice@ppc-online.com) • 1-800-800-6652 • +1 315-431-7200 • [www.ppc-online.com](http://www.ppc-online.com)