

# WISP Enclosure

## Installation Instructions



### Overview

The Wireless Internet Service Provider (WISP) Enclosure is a small multifunction enclosure designed to meet the needs of multiple wireless applications with a consistent platform. The enclosure is a great fit for WISP applications, LORAWAN, WAPs, and more, utilizing DIN rail mount components. The base enclosure includes numerous features to provide wireless network installers maximum flexibility and ease of configuration in the field. Additional options include pre-installed power, a simple battery backup, and Ethernet POE switch packages to ensure consistent configurations, saving deployment and verification time with 100% factory testing.



PPC Part #	Description
E3T-L0C0M1J1-17	ENCLOSURE, DIN3, FILTER, LEV0, COM0, MISC1, WISP1, CREAM
E3F-L1C0M1J1-17	ENCLOSURE, DIN3, FAN, LEV1, COM0, MISC1, WISP1, CREAM

### Enclosure Mounting

#### Wall Mount

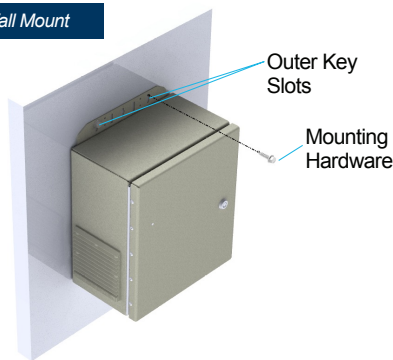

1. Measure distance of enclosure's four corner key slots
2. Drill pilot holes
3. Loosely install top screw at outer key slots
4. Level enclosure horizontally and vertically
5. Tighten top screws securely
6. Install bottom screws at outer key slots

#### Pole Mount with Banding



1. Loosely install top and bottom stainless-steel bands through enclosure slots
2. Tighten top band securely
3. Level enclosure horizontally and vertically
4. Tighten bottom band securely

#### Pole Mount with Lag Screw

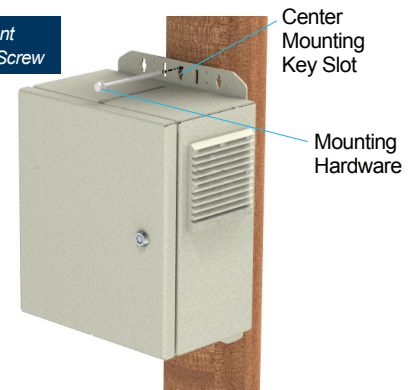

1. Measure distance of enclosure's center mounting key slots
2. Drill pilot holes
3. Install top lag screw at top center key slot
4. Level enclosure horizontally and vertically
5. Install bottom lag screw at bottom center key slot

### Hardware Installation

#### 2 Batteries Left

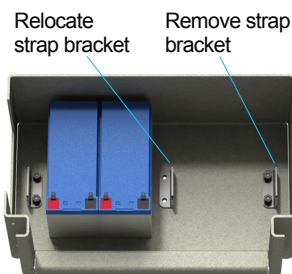

1. Battery install configurations: 4 batteries | 2 batteries left | 2 batteries right
2. For 2 battery configuration, removed one outer strap bracket, save hardware
3. Install strap bracket at one of center mounting locations using provided mounting screws and reuse hardware
4. Secure hardware and install batteries

#### Battery Mounting Hardware

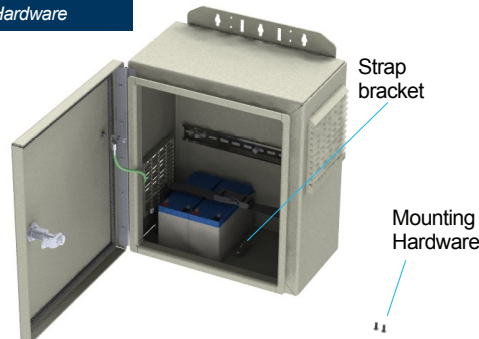

#### Grounding and Cable Glands

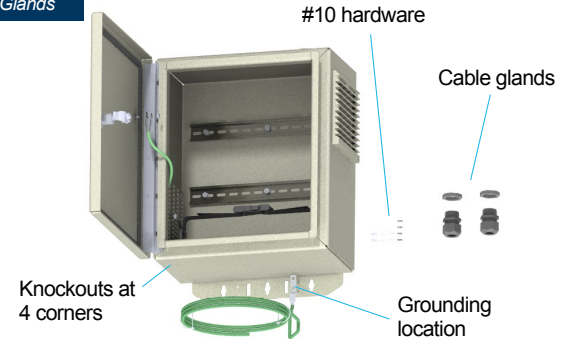

1. Install ground cable to lower mounting bracket studs
2. Secure with provided hardware
3. Cable entry/exit locations: 4 corners of bottom panel
4. Remove desired knockout and install cable glands
5. Torque cable glands to 80-85lbs [9.0-9.6Nm]

These products may be protected by one or more patents • For further information, please visit: [www.ppc-online.com/patents](http://www.ppc-online.com/patents)