

# AquaTight® EX 11

## EX11N716WS

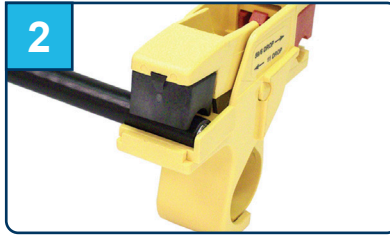

Cut the cable squarely.



Using a fixed blade prep tool in good condition, prepare cable to 1/4" x 1/4" dimensions.

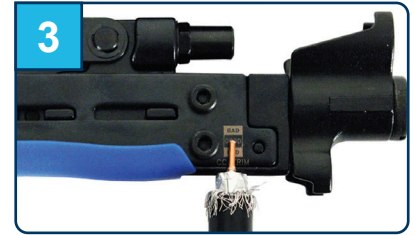

Ensure cable is prepared to 1/4" x 1/4" dimensions.



Ensure there is no dielectric, braid or foil wrapped around center conductor. Fold back braid.



If tri-shield or quad, remove outer layer of foil.

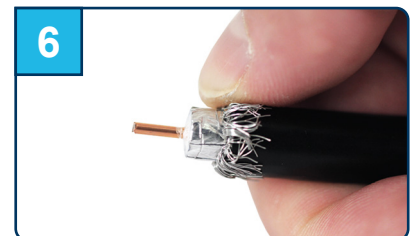

Fold back inner braid.

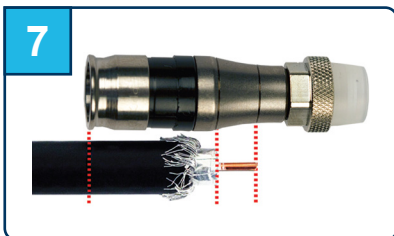

Align center conductor and dielectric with marking grooves on connector body.

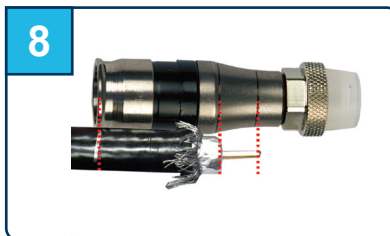

Mark cable at the base of the connector with thumbnail or other marking device.

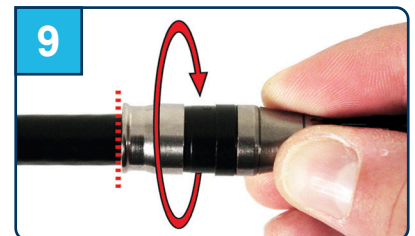

Insert cable into connector and push firmly while rotating clockwise until the connector reaches the mark on the jacket.



Properly seat connector into VT-200 tool and compress.



Visually inspect to ensure connector is fully compressed. Tighten to recommended torque.



EX11N716WS

VT-200

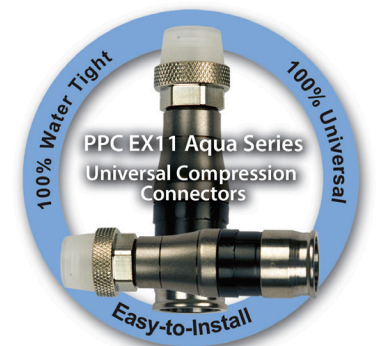

Part Number	Description
EX11N716WS	EX AquaTight® Series 11 Compression Connector
VT-200	Universal compression tool, "XL" series body

This product may be protected by one or more patents • For further information, please visit: [www.ppc-online.com/patents](http://www.ppc-online.com/patents)

customerservice@ppc-online.com • 1-800-800-6652 • [www.ppc-online.com](http://www.ppc-online.com)