

CSPB/TSPB Install Instructions

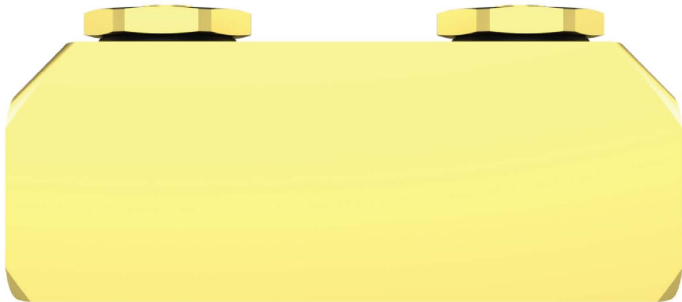

PRODUCT IMAGE:



1. Remove caps from adapter; loosen both seizure screws to ensure that the connector pin spins freely during installation.
2. Measure and trim pins of the connectors to 1/2" as shown below.
3. Hand tighten the connectors into the Splice Block.
4. With appropriate wrenches, hold the Splice Block and tighten the connectors an additional 1/8 to 1/4 turn (20-25 ft/lb)..
5. Install the prepared cable(s) into the connectors(s) and tighten per the connector manufacturer's installation instructions.
6. Tighten the seizure screws of the adapter.
7. Hand tighten the caps onto the open ports of the adapter, then tighten an additional 1/8- 1/4 turns with a wrench.

