



InLine Aerial Closure Instruction Manual

InLine Aerial Closure Instruction Manual



Table of Contents

PPC Overview	2
Kit Contents	3
Recommended Tools	3
Distribution Cable Instructions	4-7
Drop Cable Instructions	8-10

PPC Fiber Optic Solutions Overview

With millions of homes connected worldwide, PPC Broadband, Inc. (“PPC”) leads the way with innovative fiber optic, coaxial and category solutions, essential for the development and implementation of xTTx® networks. We are a market leader in high performance connectivity solutions that simplify the installation and maintenance of communications networks. PPC is a Belden brand with revenues of over \$400 million focused on the broadband, telecom, and 5G markets.

PPC offers:

- Global manufacturing footprint
- In-house product design and development
- Plug-and-play systems for rapid deployment
- Local technical and customer service support
- Multi-technology broadband and fiber connectivity solutions
- Optimized solutions tailored to the application
- A passion for innovation and technical excellence
- Provides solutions that are simpler, faster and better



InLine Aerial Closure Instruction Manual



Kit Contents

Item	Description	Quantity
1	8 Port InLine Aerial Closure	1 unit
2	Splitter Module – G.657.A1 tails	1 unit
3	Drop Cable Port Sealing Plugs	8 pcs
4	G657A1 Pigtail - 1 meter long	1 pc
5	M29 x 8 Stainless Steel Self-Tapping Thermoplastic Screws	8 pcs
6	Figure 8 Distribution Cable Strength Member Clamps – 6 mm	2 pcs
7	Figure 8 Distribution Cable Sealing Grommets	2 pcs
8	Round Distribution Cable Clamps – 12.2 mm	2 pcs
9	Round Distribution Cable Sealing Grommets – 12.2 mm	2 pcs
10	M35 x 8 Stainless Steel Self-Tapping Thermoplastic Screws	4 pcs
11	40 mm Long Splice Protectors	2 pcs
12	900 um Buffer Tube	1 m
13	350 mm Long Cable Tie	1 pc
14	100 mm Long Cable Tie	4 pcs
15	Electrical/Insulation Tape	10 m
16	Instruction Guide	1 pc

Recommended Tools

- Fusion Splice Machine
- Fiber Cleaver
- Pozi Screwdriver (size PZ0)
- Cable Stripping Tools
- Side Cutting Pliers
- Fiber Stripper

InLine Aerial Closure Instruction Manual



Distribution Cable Instructions

Step 1: Locate to ideal position for the closure along the distribution cable and mark two positions for the rubber grommets (375 mm apart).

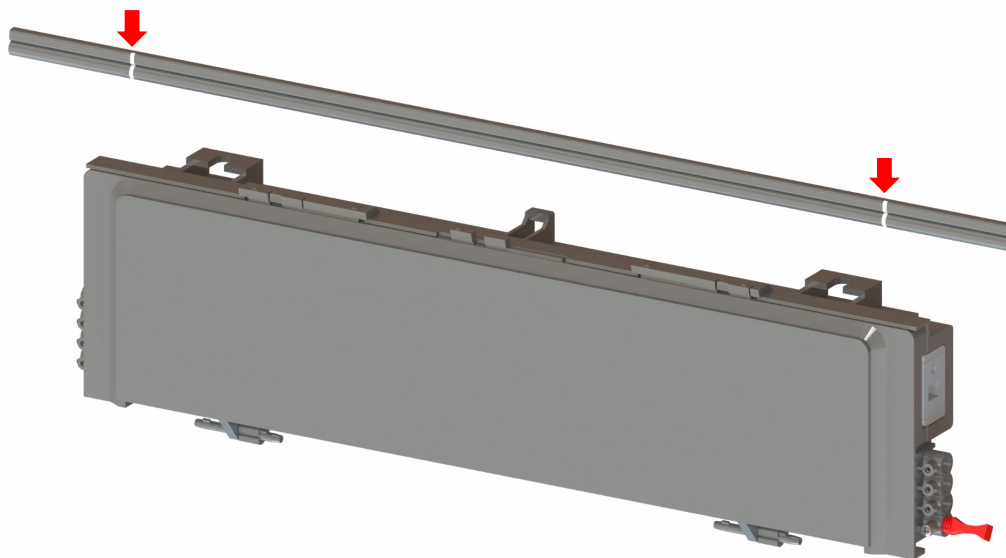

Step 2a: For Round Cable: Per the manufacturer's instructions, strip the outer jacket and prepare, then window-cut the appropriate loose tube to access the fibers.

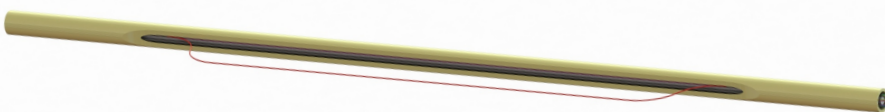

Step 2a: For Figure 8 Cable: Per the manufacturer's instructions, strip the outer jacket and prepare, then window-cut the appropriate loose tube to access the fibers.

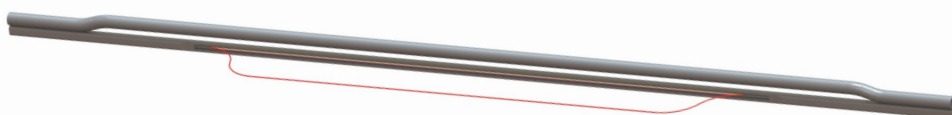

InLine Aerial Closure Instruction Manual



Distribution Cable Instructions

Step 3: Position the rubber cable grommets (shown in red) over the distribution cable in the positions marked in Step 1.

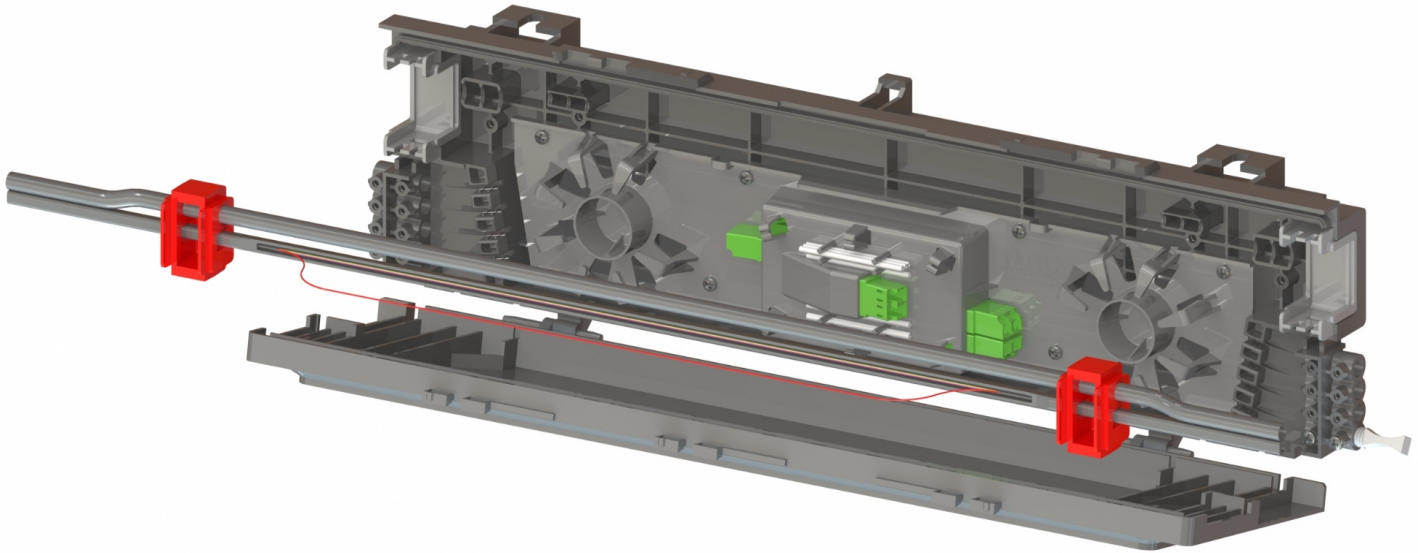

Step 4: Fit the closure over the distribution cable and securely seat the cable grommets into the closure port locations.

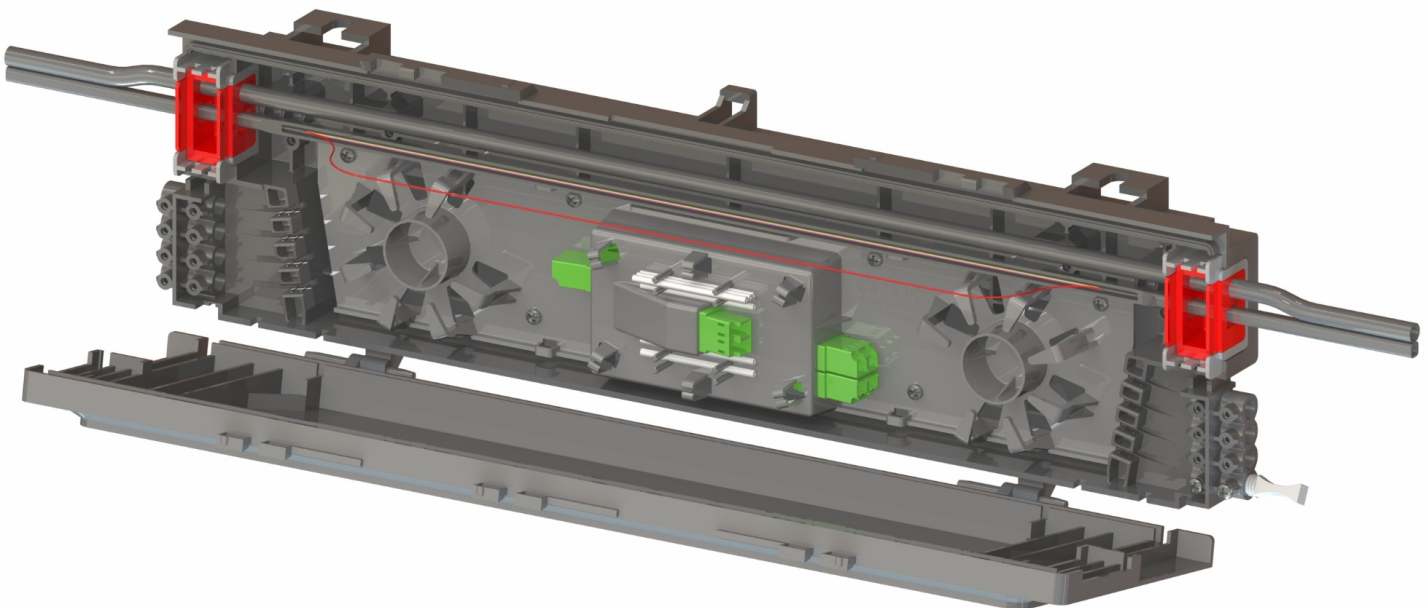

InLine Aerial Closure Instruction Manual



Distribution Cable Instructions

Step 5: Fit the cable retention brackets (shown in red) over the cable/strength member and secure with screws (M3.5 x 8.0) provided. The Round Cable is shown in yellow.

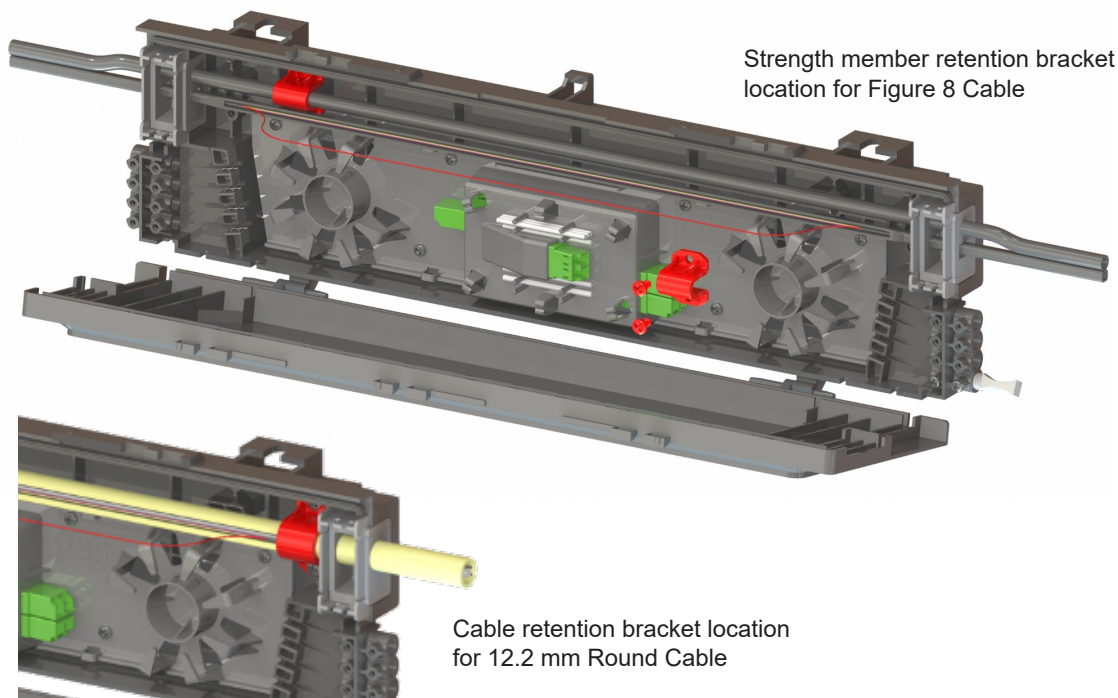

Step 6: Identify and cut the appropriate optical fiber. Sleeve the 250 μ m fiber with the 900 μ m buffer tubing provided to increase its protection.

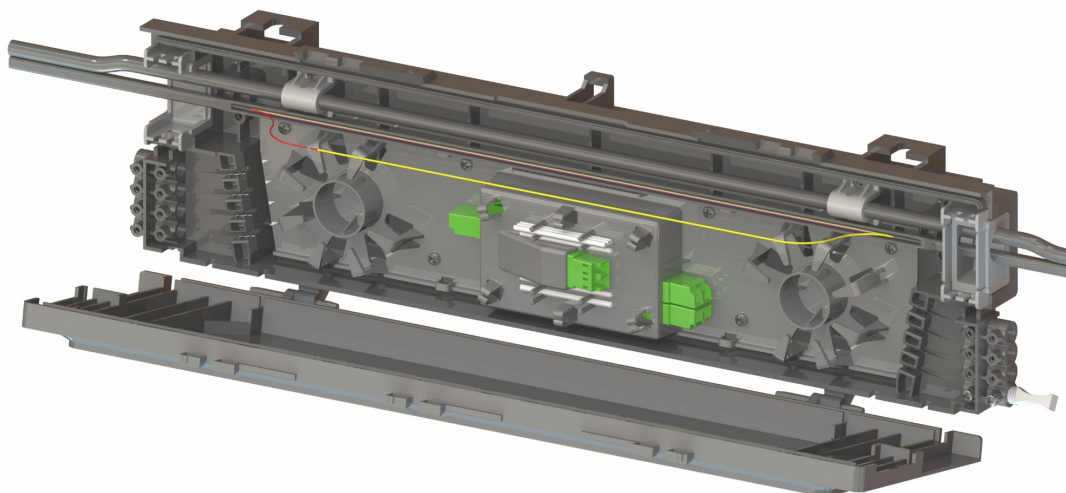

InLine Aerial Closure Instruction Manual



Distribution Cable Instructions

Step 7: Splice the fiber onto the connectorized pigtail provided. Coil the excess fiber into the storage area and plug the connector into the appropriate splitter input adapter.

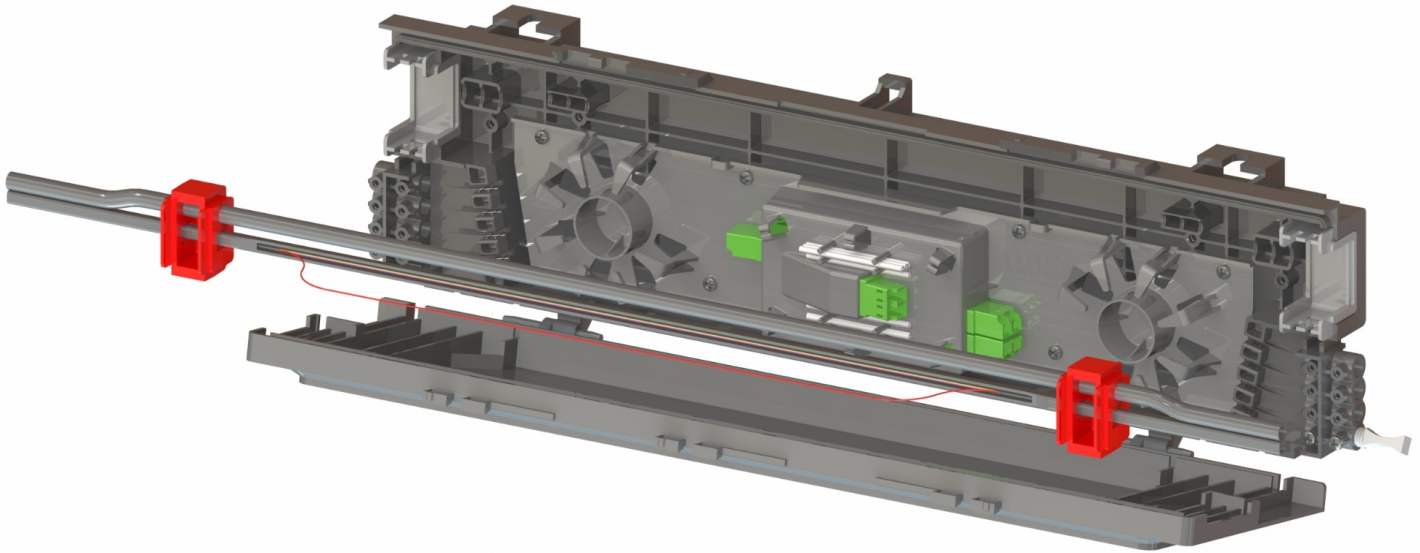

InLine Aerial Closure Instruction Manual



Drop Cable Instructions

Step 1: Loosen the two M2.9 x 8 retaining screws from the appropriate drop cable port and remove the sealing plug.

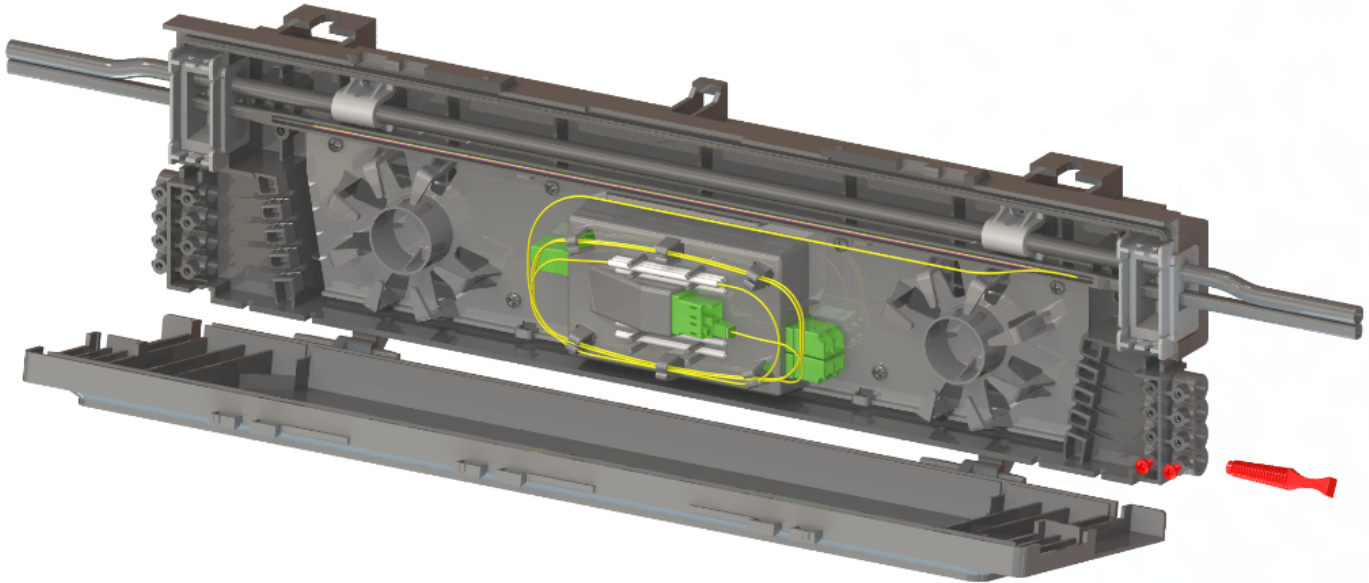

Step 2: Insert the ADSS cable through the port opening ensuring the outer jacket terminates inside the closure.

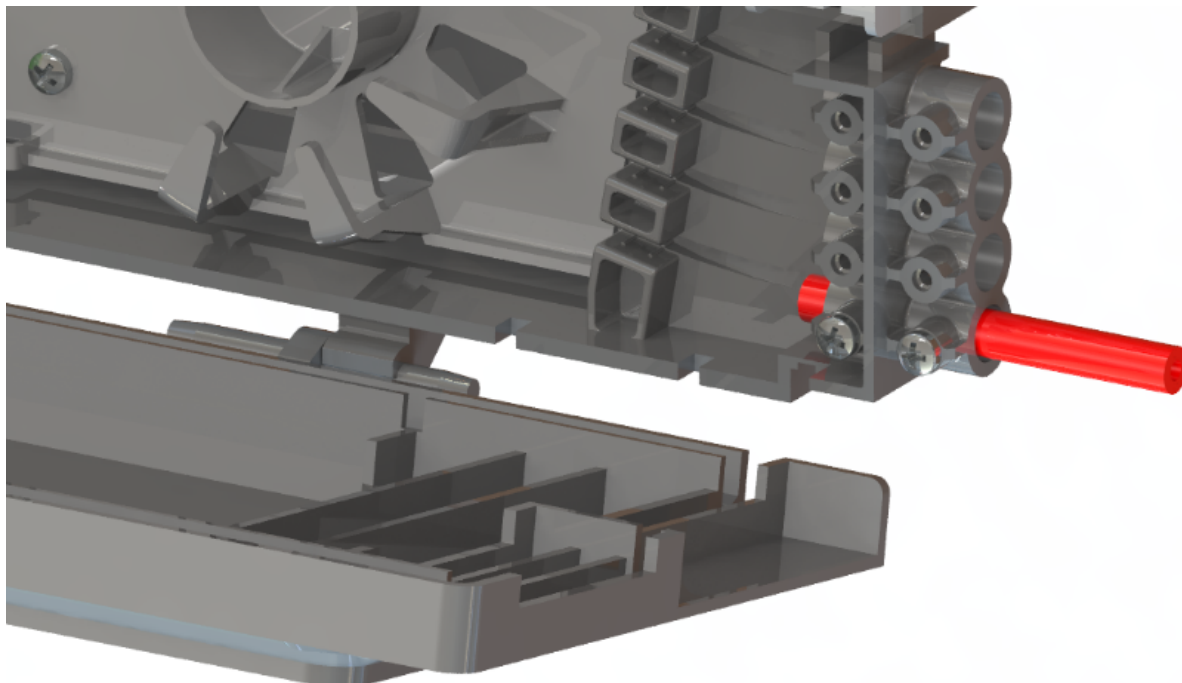

InLine Aerial Closure Instruction Manual



Drop Cable Instructions

Step 3: Align the Miniflex® cable grooves with the retention ribs and seat securely by pressing the cable firmly into place.

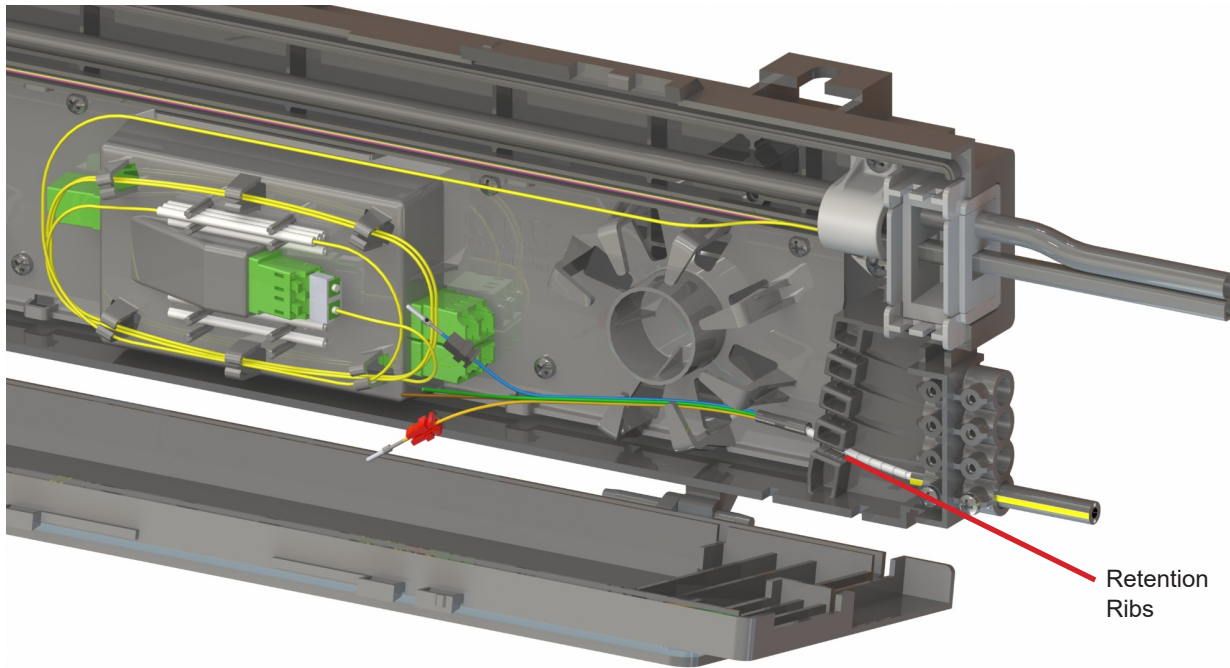

Step 4: Re-tighten the two M2.9 x 8 screws to secure the ADSS outer jacket into the drop cable port.

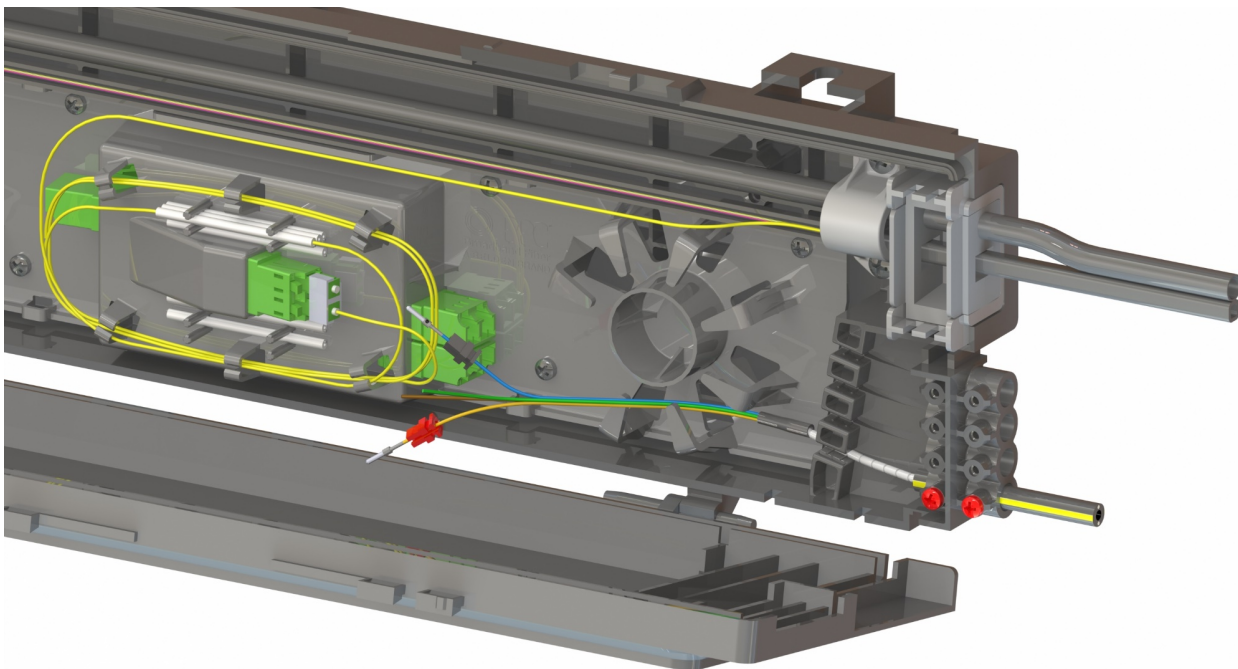

InLine Aerial Closure Instruction Manual



Drop Cable Instructions

Step 5: Fit the Balistix connector components to the ferrules as per separate QuikDrop™ cable instructions.

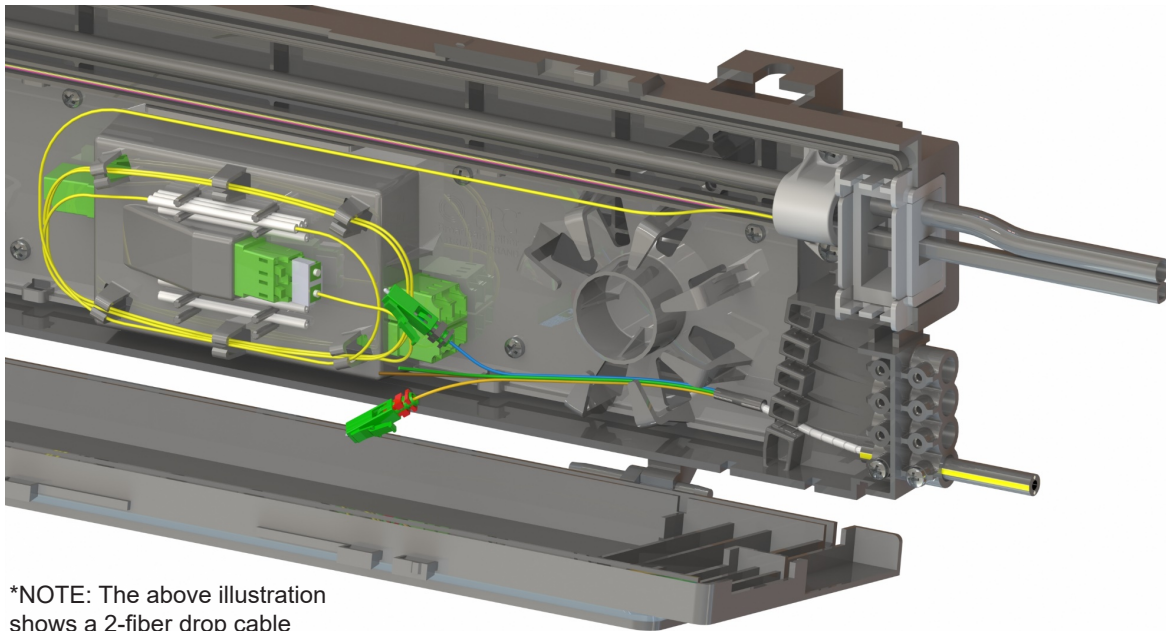

*NOTE: The above illustration shows a 2-fiber drop cable

Step 6: Coil the excess fiber tails into the storage area before plugging the connectors into the appropriate splitter output adapters.

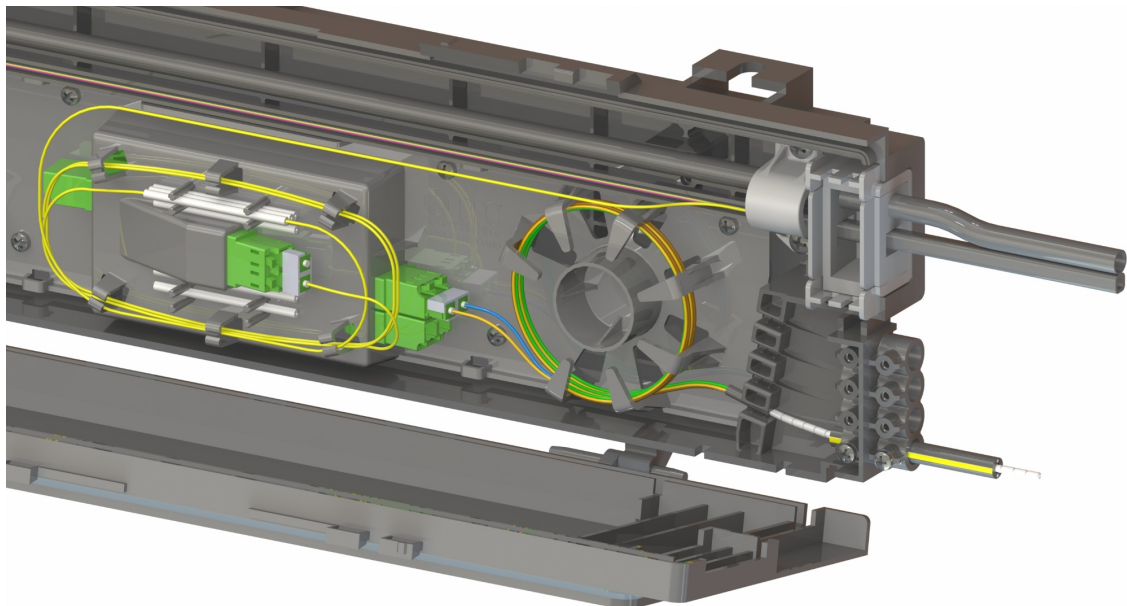

For more than 70 years, PPC has been developing and manufacturing connectivity solutions for broadband service providers. Holding more patents in connector technology than any other company worldwide, PPC continues to be a premier driver of innovation and technical leadership.

HEADQUARTERS
Syracuse, New York

6176 East Molloy Road
East Syracuse, New York 13057

TEL: 315-431-7200
FAX: 315-431-7201

